

**REPT
BATTERO**

TSINGSHA

Energy Storage solutions

REPT ENERGY

DRIVING A SUSTAINABLE FUTURE



COMPANY

INTRODUCTION

»» Tsingshan Holding Group

Tsingshan Industry has invested in the new energy field by combining its rich mineral resources. Adhering to the mission of 'Refining a hundred years of stainless steel, building a green future', REPT BATTERO enjoys the unique resource integration ability and synergy advantage of the whole industrial chain conferred by Tsingshan Industry, and has become one of the fastest-growing battery producers in the industry.

NO.1

Global stainless steel crude steel production output

NO.1

Global nickel metal production output

NO.247

Fortune Global 500 companies in 2025

185000+

Total employees in 2025

»» REPT BATTERO

REPT BATTERO Energy Co., Ltd. was established in 2017. As the first new energy enterprise deployed by Tsingshan Industrial, a Fortune Global 500 company, it focuses on the R&D, production, and sales of lithium-ion batteries, providing solutions for new energy vehicle power and smart energy storage.

The company has R&D centers in Shanghai, Wenzhou, and Jiaxing, and production bases in Wenzhou, Jiaxing, Liuzhou, Foshan, and Chongqing. Its first overseas battery factory in Indonesia is under construction. By 2025, the company's total production capacity is expected to exceed 90GWh.

In 2024, it ranked 5th globally in energy storage cell shipments, 2nd globally in household energy storage battery shipments, 3rd nationwide in new energy heavy-duty truck installation volume, and 6th domestically in lithium iron phosphate (LFP) power cell shipments. In the first half of 2025, it ranked 2nd nationwide in heavy-duty truck battery shipments. In the first three quarters of 2025, it ranked 1st globally in both household energy storage battery shipments and commercial & industrial energy storage battery shipments.

BNEF Tier1

BloombergNEF Tier 1 Energy Storage Manufacturers

\$ 2.5 Billion

Sales revenue in 2024

NO.1

Global Shipments of Household Energy Storage Batteries & Commercial & Industrial Energy Storage Batteries in the First Three Quarters of 2025

NO.5

Global Energy Storage Battery Shipments in 2024

»» Main Business

Supplying power battery systems and services for green transportation networks



Cells



Modules



Battery Packs

Supplying solutions and services for clean energy storage



Electrical Cabinet



Energy Storage Systems



Energy Storage Stations

»» Manufacturing Plant



WENZHO, CHINA



LIUZHOU, CHINA



CHONGQING, CHINA



JIAXING, CHINA

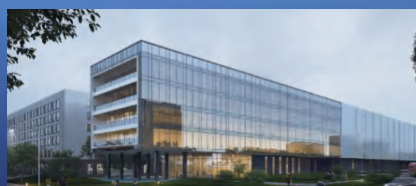

FOSHAN, CHINA



MALUKU, INDONESIA

» Energy Storage Cells

Residential



Capacity	50Ah	72Ah	100Ah	100Ah	100Ah
Nominal Voltage	3.2V	3.2V	3.2V	3.2V	3.2V
Voltage Range	2.50-3.65V	2.50-3.65V	2.50-3.65V	2.50-3.65V	2.50-3.65V
Cycle life	7000cycles	6000cycles	6000cycles	3500cycles	5000cycles
Dimension	39x148x101(mm)	39x148x111(mm)	52x148x119(mm)	52x148x119(mm)	27x173x207(mm)
Mass	1.13±0.10(kg)	1.40±0.10(kg)	1.91±0.10(kg)	1.87±0.10(kg)	2.05±0.15(kg)
Certificate	UL9540A,UL1973,IEC62619,SII, JIS8715-2,UL1642,UN38.3	UL9540A,UL1973, IEC62619,UN38.3	UL9540A,UL1973,IEC62619, UN38.3,JIS8715-2	UL9540A,UL1973, IEC62619,UN38.3	UL9540A,UL1973, IEC62619,UN38.3

Utility and C&I



Capacity	280Ah	314Ah	314Ah	392Ah	588Ah
Nominal Voltage	3.2V	3.2V	3.2V	3.2V	3.2V
Voltage Range	2.50-3.65V	2.50-3.65V	2.50-3.65V	2.50-3.65V	2.50-3.65V
Cycle life	10000cycles	10000cycles	12000cycles	12000cycles	12000cycles
Dimension	71x173x207(mm)	71x173x207(mm)	71x173x207(mm)	75x182x224(mm)	72x288x216(mm)
Mass	5.48±0.15(kg)	5.60±0.15(kg)	5.70±0.15(kg)	6.84±0.2(kg)	10.2±0.30(kg)
Certificate	UL1973,UL9540A,IEC62619,UN38.3,UL1642,GB/T 36276	UL1973,UL9540A,IEC62619,UN38.3,UL1642,GB/T 36276,GB44240-2024,JIS C8715-2:2024,IEC62620	UL1973,UL9540A,IEC62619,UN38.3,UL1642,GB/T 36276,GB44240-2024,JIS C8715-2:2024,IEC62620	UL1973,UL9540A,IEC62619,UN38.3,UL1642,GB/T 36276,GB44240-2024	UL1973,UL9540A,IEC62619,UN38.3,UL1642,GB/T 36276,GB44240-2024

Energy Storage System Product Matrix



	Y52 Module	Y104 Module	C&I All-in-One Cabinet	Battery Cabinet
Grouped Configuration	1P52S	1P104S	1P260S	1P416S
Nominal Voltage	166.4Vdc	332.8Vdc	400Vac, 3L/N/PE	1331.2Vdc
Voltage Range	130-189.8(Vdc)	260V-379.6(Vdc)	676-936(Vdc)	1164.8-1497.6(Vdc)
Nominal Energy	46.6kWh	104.5kWh	261.2kWh	417.99kWh
Dimension	1120×810×238(mm)	2150.5×779×250(mm)	1050×2250×1400(mm)	1400×1340×2360(mm)
Mass	330kg	690kg	2.58t	3.7t



	Powtrix-i(BV) All-in-One ESS	Powtrix 1.0 DC Container	Powtrix 2.0 DC Container	Powtrix 3.0 DC Container
Grouped Configuration	416S10P	416S10P	416S12P	416S12P
Nominal Voltage	DC 1331.2V AC 690V	1331.2V	1331.2V	1331.2V
Battery Voltage Range	1040V-1500V	1040V-1500V	1040V-1500V	1040V-1500V
Nominal Energy	2.09MW, 4.18MWh	3.727MWh	5.016MWh	6.25MWh
Dimension	10080x2440x2940(mm)	6058×2438×2896(mm)	6058×2438×2896(mm)	6058×2438×2896(mm)
Nominal Mass	44.9t	36t	44.5t	49t

Energy Storage Project Highlight



Morowali Industrial Park (IMIP), Indonesia
150 MWh



Texas, USA
226 MWh



Texas, USA
130 MWh



New South Wales, Australia
1,680 MWh



California, USA
117.5 MWh



Xinjiang, China
800 MWh



Chongqing, China
400 MWh



Ningxia, China
400 MWh



Ningxia, China
200 MWh



Sofia Bulgaria
7.45 MWh



Ningxia, China
300 MWh



Trzhitsa, Bulgaria
7.45 MWh

ESG Management



Supply Chain Traceability Management

01



Energy Utilization

02



Battery Recycling

03



Waste Emissions and Utilization

04



Employee Production Safety and Health

05



Corporate Social Responsibility System

06

ESG

ESG Achievements

- "Participating Companies in the United Nations Global Compact (UNGC) 'SDG Ambition Accelerator'"
- Responsible Business Alliance (RBA) Silver Level Certification
- GB/T 39604-2020 Corporate Social Responsibility Management System Certification
- The "2024 Greenlight ESG List Exemplary Case - Exemplary Innovation Contribution List TOP10"
- The "2024 Annual Innovation Award - Energy Conservation and Emission Reduction Technology Progress Award" and the "Carbon Neutrality Field Technology Progress Award" issued by the China Energy Conservation Association and the China Quality Certification Center.



Liuzhou Base was awarded Guangxi Zhuang Autonomous Region GreenFactory



Liuzhou Base was awarded Guangxi Intelligent Demonstration Manufacturing Enterprise



Jiaxing Base was awarded Jiaxing city Green Factory



Wenzhou Base and Liuzhou Base were awarded National-level Green Factory



We will establish a development system aligned with the United Nations Sustainable Development Goals, creating a safe and healthy workplace for all employees and a green, eco-friendly community environment to ensure sustainable and rapid growth.

Global Industrial Layout

■ Annual production of 30,000 tons of battery-grade cobalt sulfate

■ Annual production of 20,000 tons of AG artificial graphite

■ > 9 million tons of nickel metal reserves

■ Resource integration and synergy



● Planned Production Capacity For 2025
90GWh+

● R&D Center
Jiaxing | Shanghai
Wenzhou

● Production Base
Wenzhou | Jiaxing | Liuzhou
Foshan | Chongqing | Indonesia

● Indonesia Base
Under Construction

REPT BATTERO Energy Co.,Ltd.

📍 **R&D Center**
Jiaxing Wenzhou Shanghai, China
Email:market@reptbattero.com

📍 **Production Base**
Wenzhou Jiaxing Liuzhou Foshan Chongqing, China
Indonesia
Email:market@reptbattero.com

📍 **American Subsidiary**
REPT BATTERO AMERICAN CORPORATION
Address:California USA
Email:info.us@reptbattero.com

📍 **German Subsidiary**
REPT BATTERO ENERGY GERMANY GMBH
Address:Munichen Germany Subsidiary
Email:market@reptbattero.com

📍 **Indonesian Base**
Address: Maluku Indonesia
Email:market@reptbattero.com

📍 **Australian Subsidiary**
REPT BATTERO AUSTRALIA PTY LTD
Email:info.us@reptbattero.com



STOCK CODE
0666.HK